

C & K Line Major Service Change

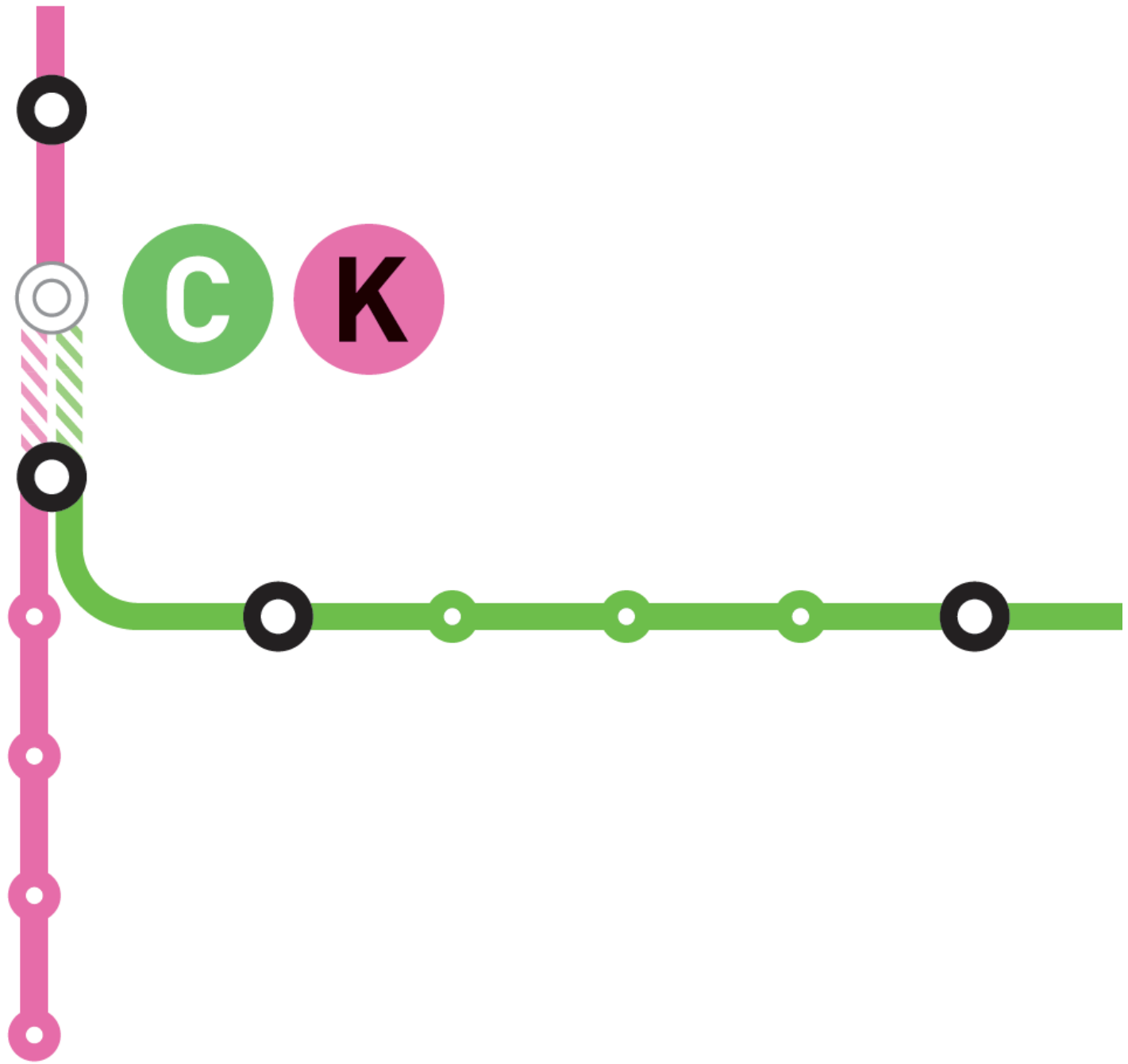

Operating Plan

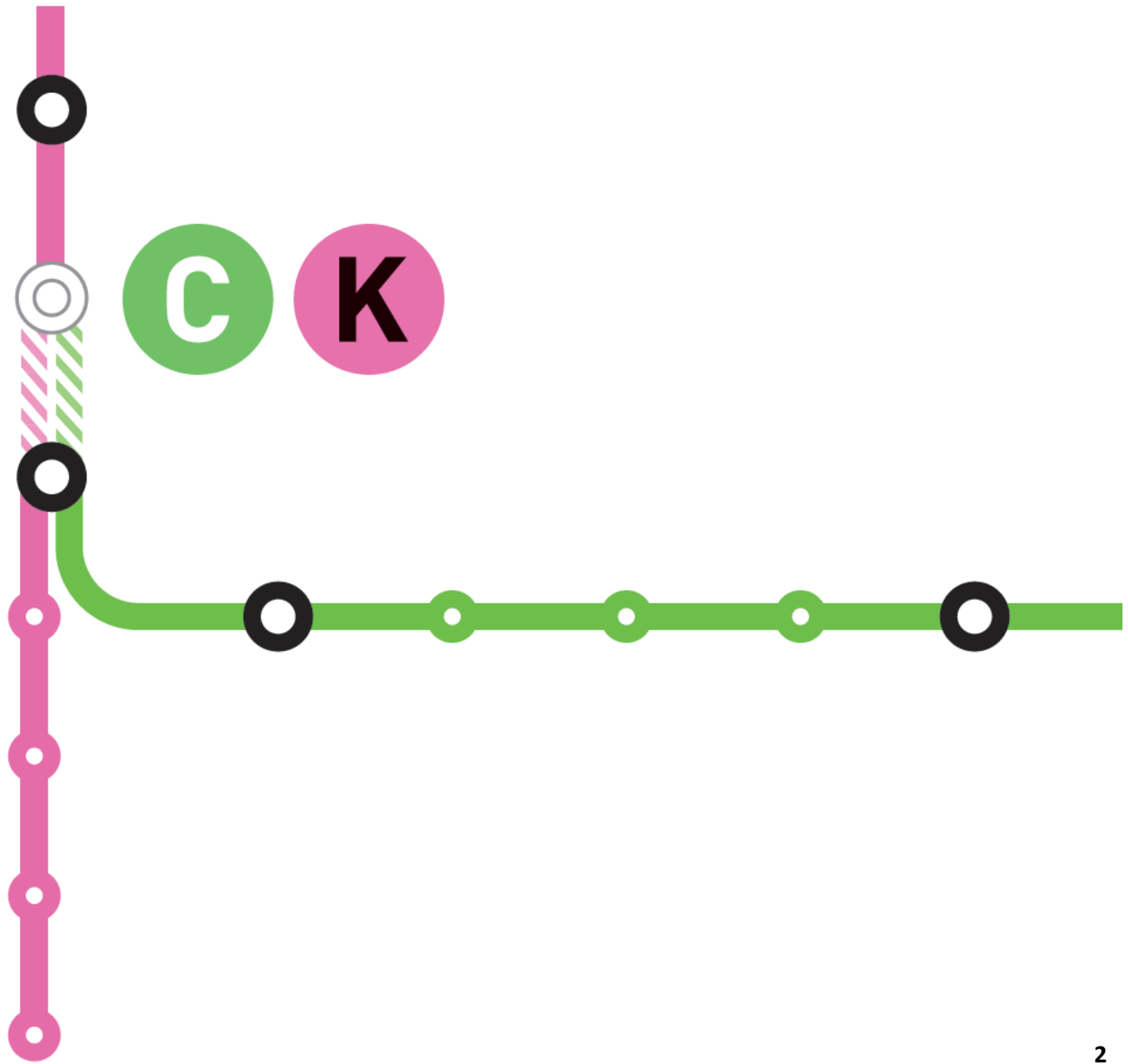

Pre-Revenue C & K Line Configuration

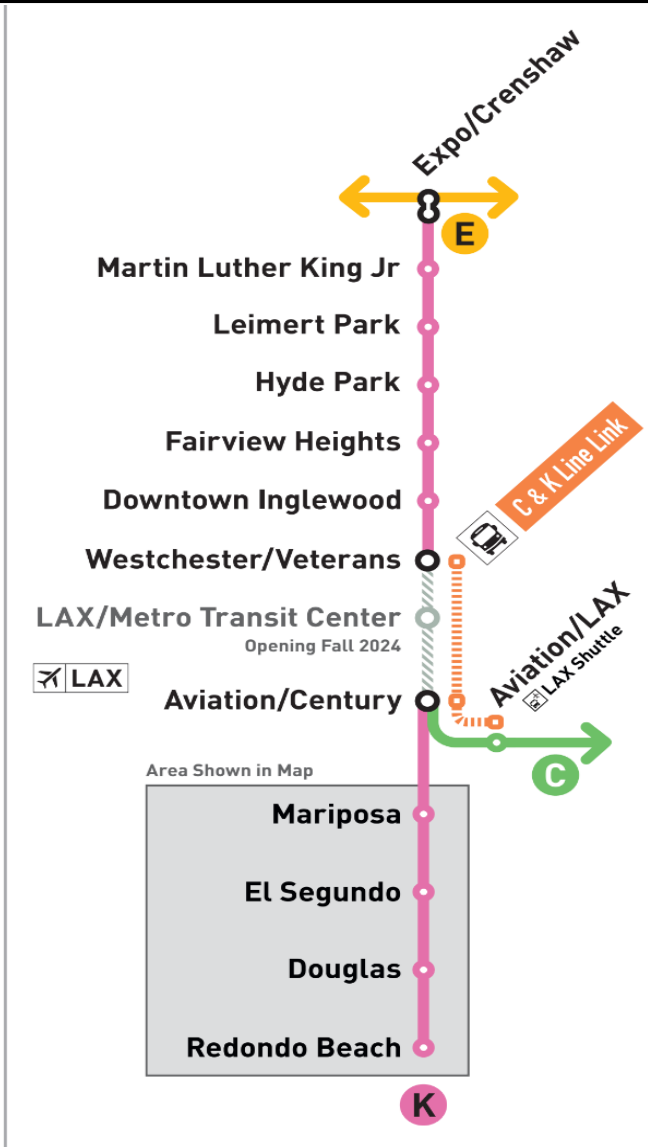

Limited pre-revenue service with special test trains weeknights and weekends commenced as of end of August 2024. Upon successful completion of limited pre-revenue service (early October), new C & K Line rail operating patterns will commence.

K Line trains will travel through LAX/Metro Transit Center, **but will not carry passengers between Westchester/Veterans and Aviation/Century**. C Line will end at Aviation/Century during this period. California Public Utilities Commission (CPUC) has confirmed Aviation/Century Station can be used.

Once full pre-revenue service is completed (approx. 8 weeks) and CPUC approval is granted for opening service to LAX/Metro Transit Center, C and K Line services will serve LAX/Metro Transit Center Station.

LAWA Metro Connector bus shuttles will serve both Aviation/Century and LAX/Aviation Stations for access to LAX terminals. C & K Line Link 857 will bridge the gap between K Line segments.

Final C & K Line Configuration

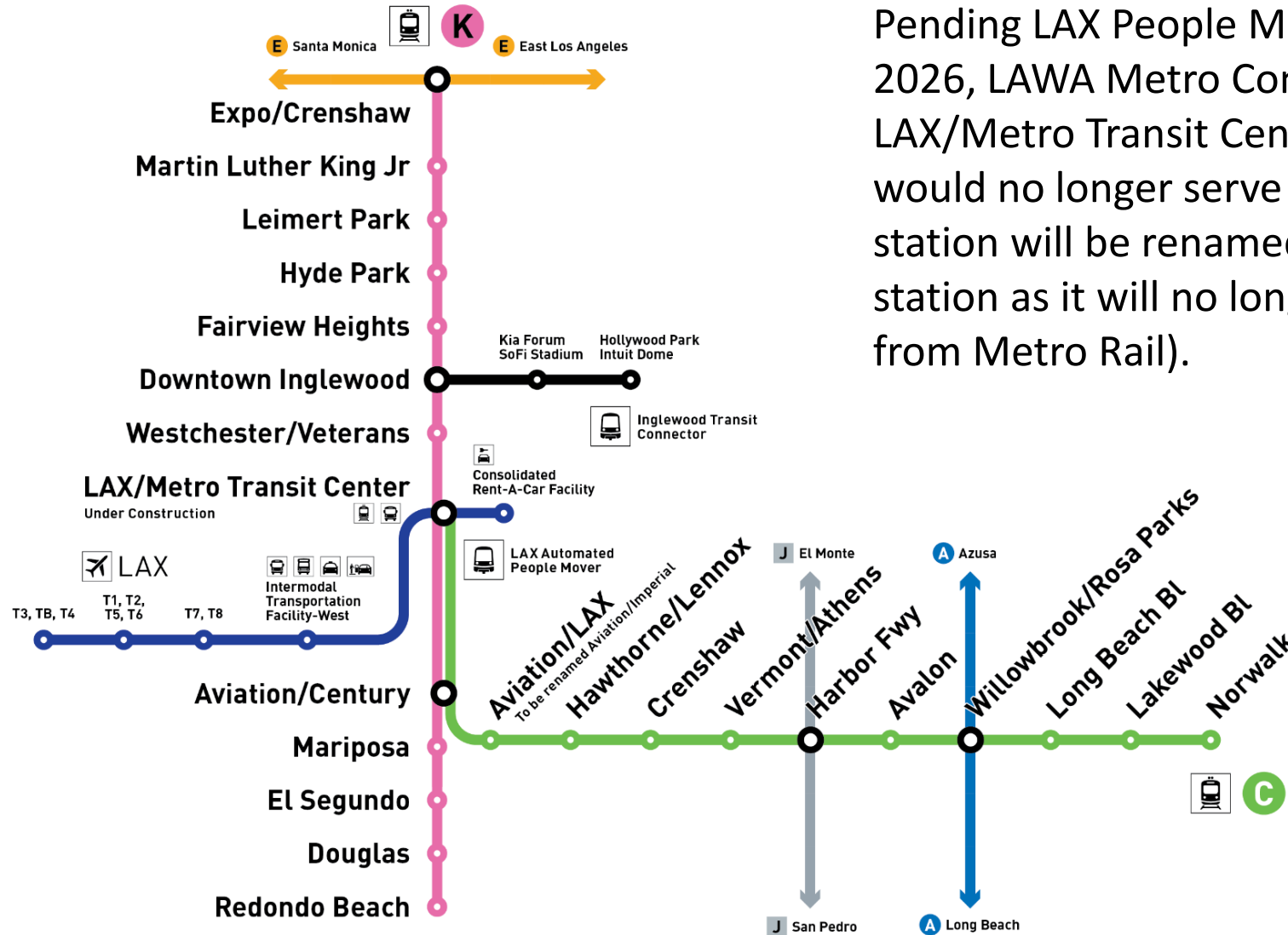

Pending LAX People Mover Train opening in early 2026, LAWA Metro Connector bus service will link LAX/Metro Transit Center with LAX terminals. It would no longer serve Aviation/LAX station (that station will be renamed back to Aviation/Imperial station as it will no longer be the gateway to LAX from Metro Rail).

LAX / Metro Transit Center Interim Bus Bay Assignments – LAWA M Shuttle temporary N →

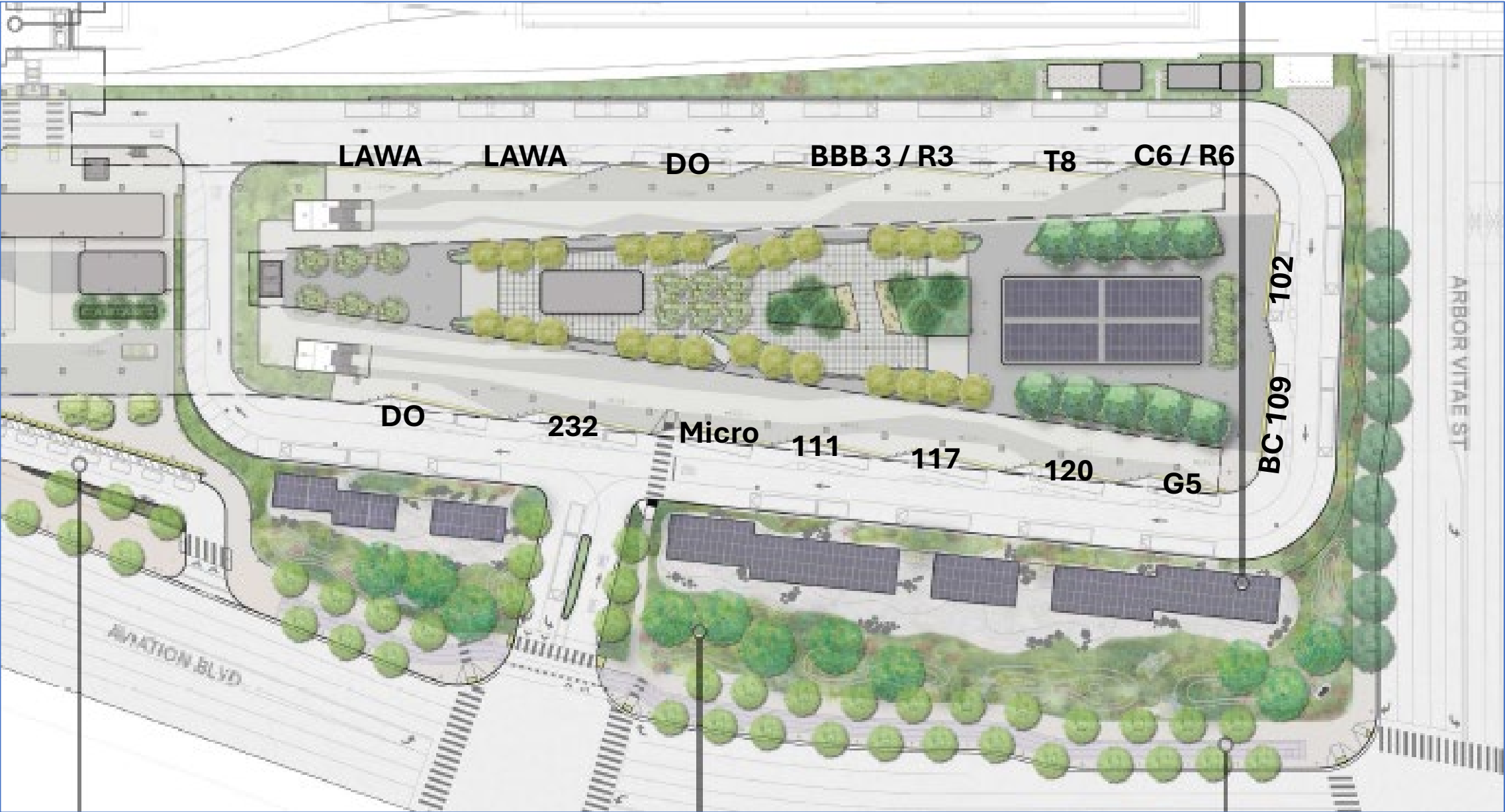

DO = Discharge Only Bay 3 and Bay 16

Communications Plan

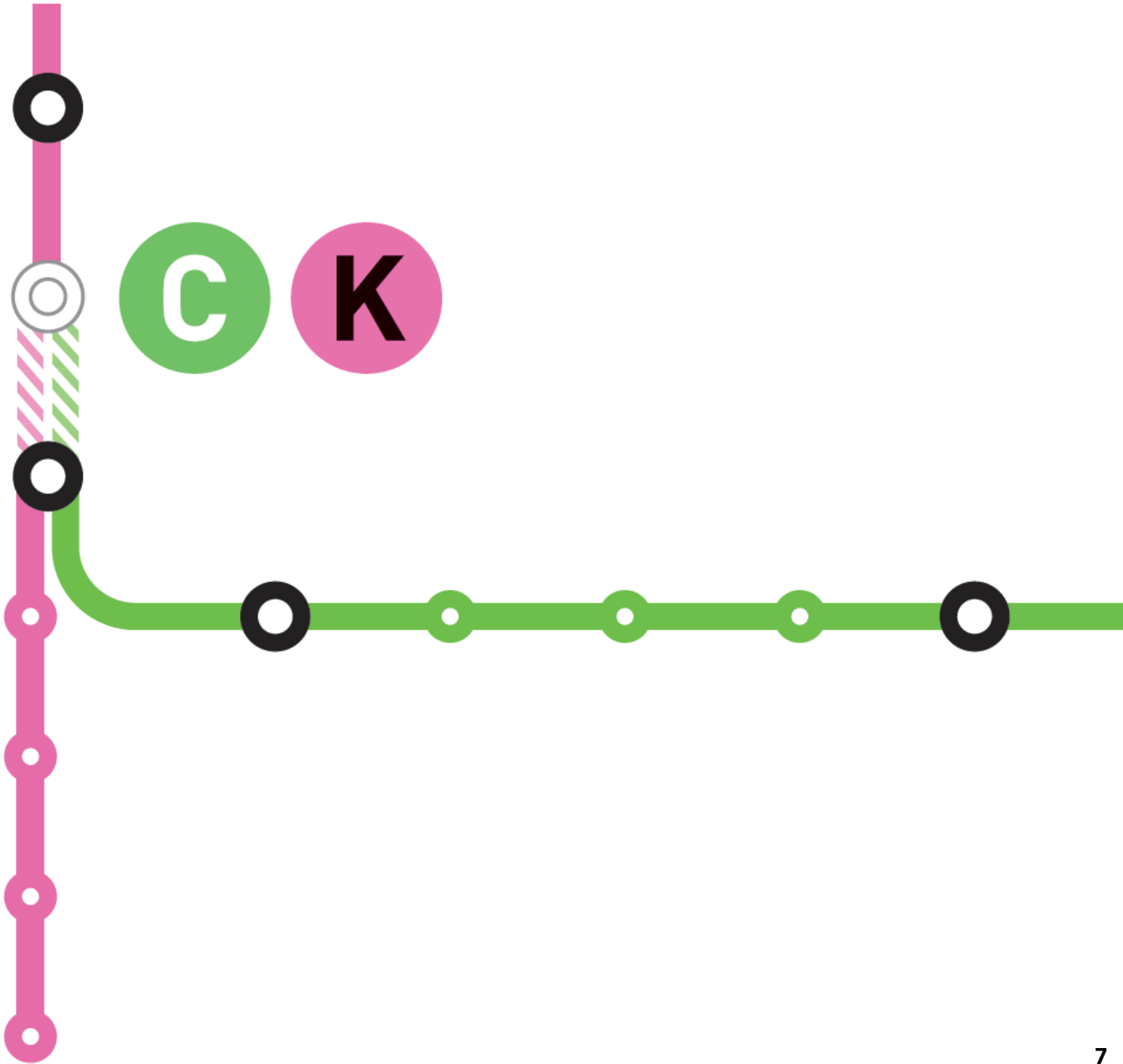

Communications Plan

Objectives

- Inform Metro Riders that beginning on a date to be confirmed in fall 2024, Aviation/Century Station will open as part of the **C & K Lines reconfiguration** when we begin train testing to prepare for the opening of the LAX/Metro Transit Center Station.
- Inform Metro Riders that existing **C & K Line Link (Metro Bus Bridge) service will continue until LAX/Metro Transit Center opens with full end-to-end K Line service (Expo/Crenshaw to Redondo Beach)** and will include the new Aviation/Century Station as a stop.
- Educate Metro Riders about why we are making these changes now and the benefits of the new service routes when the LAX/Metro Transit Center Station opens later (date to be confirmed, subject to completing pre-revenue service).

Target Audiences and Methods

- Current Metro riders
 - Primary: Current C & K Line riders. Secondary: Metro system riders
- Metro Board members and Board staff
- Businesses & BIDs (Business Improvement Districts) around impacted rail segment
 - Westchester BID, Downtown MB BID, Redondo Beach
- Local Chambers (LAX, El Segundo, Manhattan, Redondo, Torrance)
- Local and state government officials, community leaders, CBOs
- Local Media
- Campaign will involve Ambassadors, Blue Shirts, other Metro staff in person on the system distributing Take Ones, plus posters and announcements at all C & K Line Stations, meetings (such as this one), a dedicated webpage (including videos and FAQs), emails to those signed up for alerts, social media e-blasts, included in regular Metro newsletters including through Community Relations and Commuter Services, and messaging out to and through LAWA and other stakeholder networks, press releases and pro-active outreach to media. LAX/Transit Center opening event (details to follow).

Questions?

